

POLICIE ČESKÉ REPUBLIKY
KRAJSKÉ ŘEDITELSTVÍ POLICIE
PARDUBICKÉHO KRAJE
ÚZEMNÍ ODEBOR
DOPRAVNÍ INSPEKTORÁT
562 27 ÚSTÍ NAD ORLICÍ

47/696

R=2597,63m

II/311 MLADKOV

II/311 MLADKOV

R40	L = 50 m
A = 15,83 m	R = 15 m
A = 658,74 m	R = 115 m
L = 15,83 m	L = 30 m
PK 48,331 70	
2 BA	

A = 658,74 m	R = 115 m
L = 15,83 m	L = 30 m
PK 48,331 70	
2 BA	

KP 48,346 15



Výbějte odjezdu autobusu

C14a

TĚCHONÍN

IZ4a

PK 48,414 23

969/32

969/40

969/47

969/50

969/53

969/56

969/59

969/62

969/65

969/68

969/71

969/74

969/77

969/80

969/83

969/86

969/89

969/92

969/95

969/98

969/101

969/104

969/107

969/110

969/113

969/116

969/119

969/122

969/125

969/128

969/131

969/134

969/137

969/140

969/143

969/146

969/149

969/152

969/155

969/158

969/161

969/164

969/167

969/170

969/173

969/176

969/179

969/182

969/185

969/188

969/191

969/194

969/197

969/200

969/203

969/206

969/209

969/212

969/215

969/218

969/221

969/224

969/227

969/230

969/233

969/236

969/239

969/242

969/245

969/248

969/251

969/254

969/257

969/260

969/263

969/266

969/269

969/272

969/275

969/278

969/281

969/284

969/287

969/290

969/293

969/296

969/299

969/302

969/305

969/308

969/311

969/314

969/317

969/320

969/323

969/326

969/329

969/332

969/335

969/338

969/341

969/344

969/347

969/350

969/353

969/356

969/359

969/362

969/365

969/368

969/371

969/374

969/377

969/380

969/383

969/386

969/389

969/392

969/395

969/398

969/401

969/404

969/407

969/410

969/413

969/416

969/419

969/422

969/425

969/428

969/431

969/434

969/437

969/440

969/443

969/446

969/449

969/452

969/455

969/458

969/461

969/464

969/467

969/470

969/473

969/476

969/479

969/482

969/485

969/488

969/491

969/494

969/497

969/500

969/503

969/506

969/509

969/512

969/515

969/518

969/521

969/524

969/527

969/530

969/533

969/536

969/539

969/542

969/545

969/548

969/551

969/554

969/557

969/560

969/563

969/566

969/569

969/572

969/575

969/578

969/581

969/584

969/587

969/590

969/593

969/596

969/599

969/602

969/605

969/608

969/611

969/614

969/617

969/620

969/623

969/626

969/629

969/632

969/635

969/638

969/641

969/644

969/647

969/650

969/653

969/656

969/659

969/662

969/665

969/668

969/671

969/674

969/677

969/680

969/683

969/686

969/689

969/692

969/695

969/698

969/701

969/704

969/707

969/710

969/713

969/716

969/719

969/722

969/725

969/728

969/731

969/734

969/737

969/740

969/743

969/746

969/749

969/752

969/755

969/758

969/761

969/764

969/767

969/770

969/773

969/776

969/779

969/782

969/785

969/788

969/791

969/794

969/797

969/800

969/803

969/806

969/809

969/812

969/815

969/818

969/821

969/824

969/827

969/830

969/833

969/836

969/839

969/842

969/845

969/848

969/851

969/854

969/857

969/860

969/863

969/866

969/869

969/872

969/875

969/878

969/881

969/884

969/887

969/890

969/893

969/896

969/899

969/902

969/905

969/908

969/911

969/914

969/917

969/920

969/923

ZLEPŠENÍ DOSTUPNOSTI TURISTICKÝCH ATRAKTIV V OBLASTI MASIVU SNĚŽNÍKA VÝŘEZ KOORDINAČNÍ SITUACE - LOKALITA TĚCHONÍN PODJEZD

M 1:500

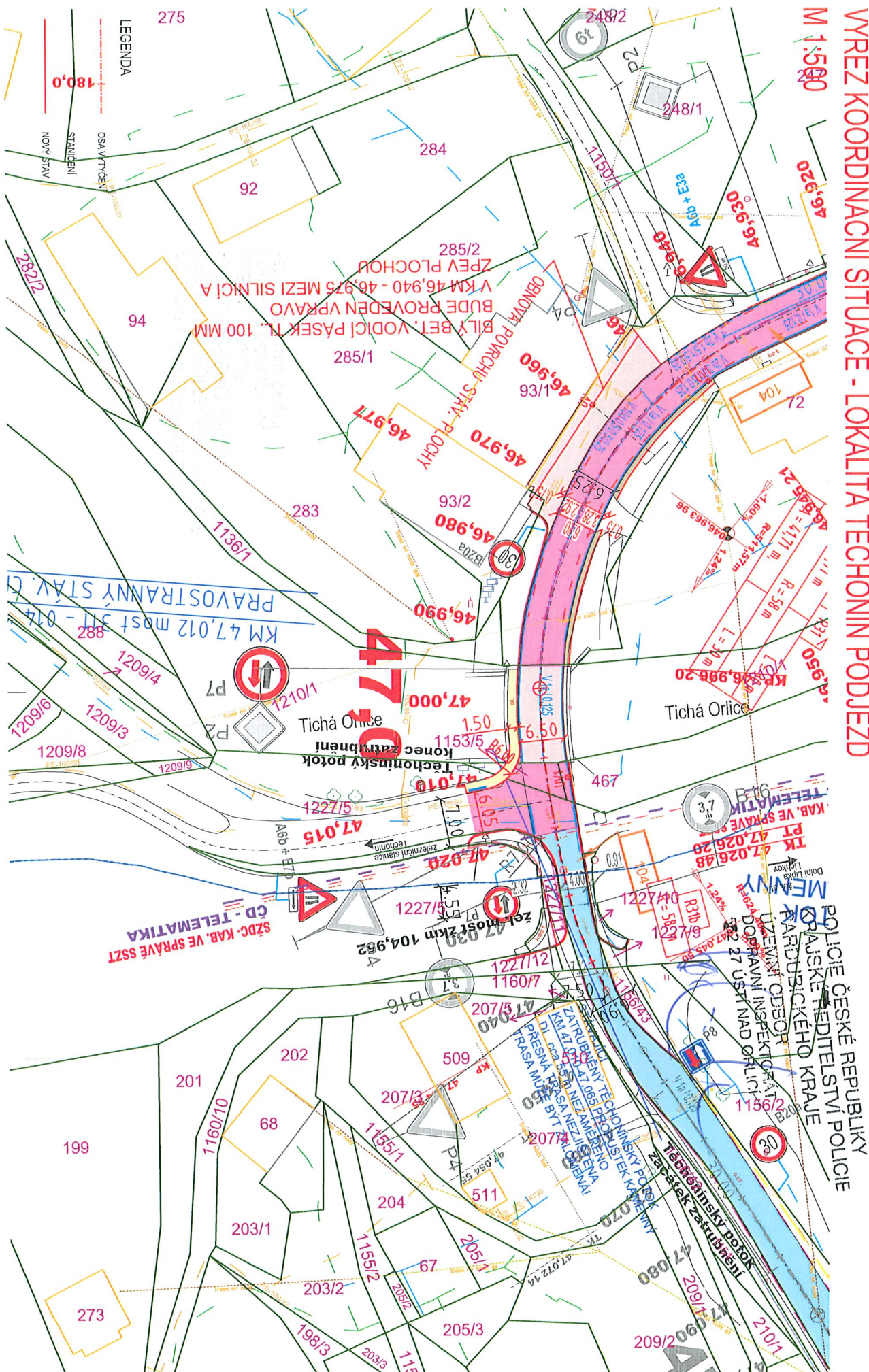

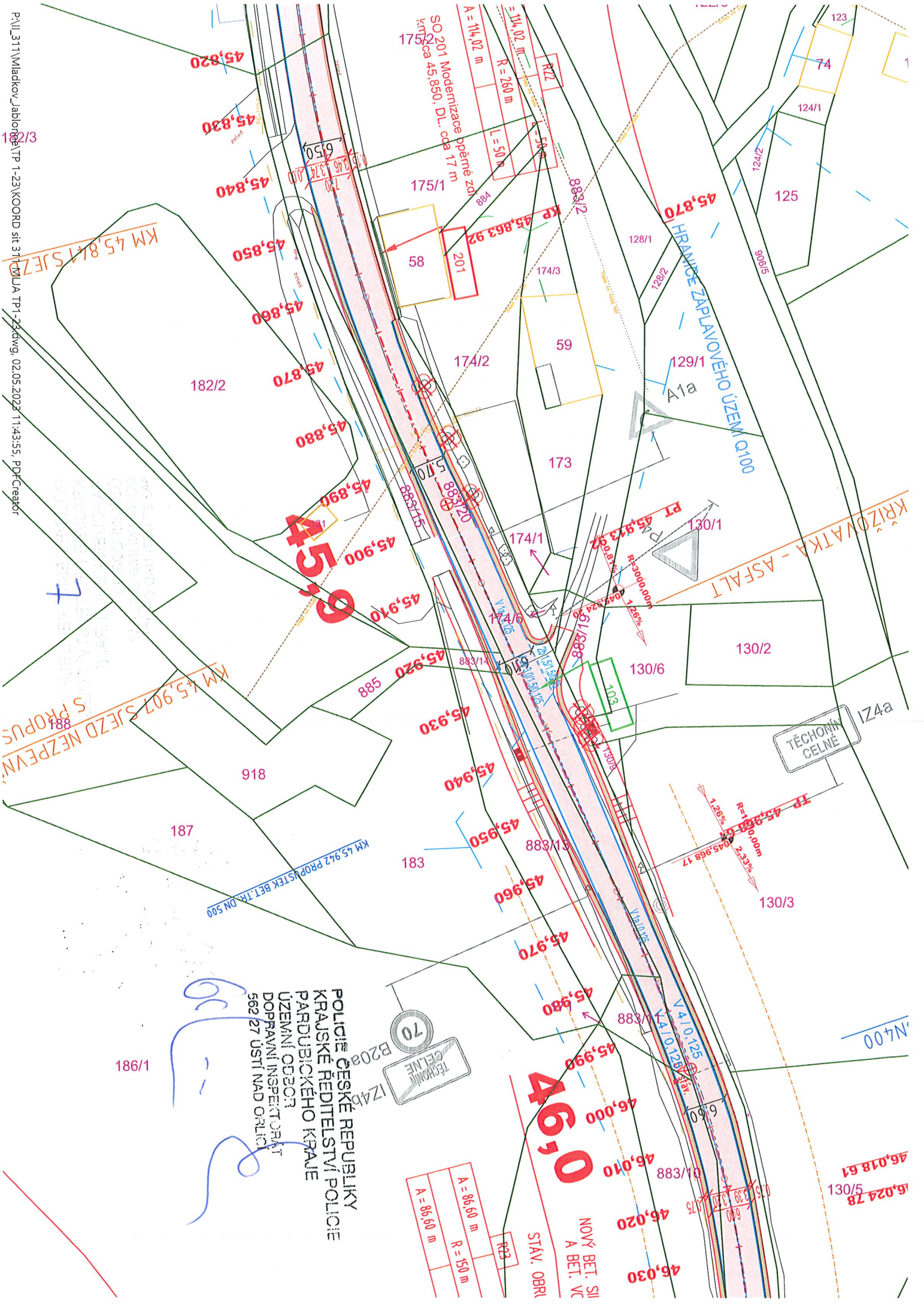

POLICIE ČESKÉ REPUBLIKY
KRAJSKÉ ŘEDITELSTVÍ POLICIE
PARDOBICKÉHO KRAJE
ÚZEMNÍ ODBOR
DOPRAVNÍ INSPEKTORÁT
562 27 USTÍ NAD ORLICÍ

A = 86,50 m	R = 150 m
A = 86,50 m	

